

NEWSEUM

VISITORS GUIDE

Map and Information



NEWSEUM NEWSEUM NEWSEUM NEWSEUM NEWSEUM NEWSEUM NEWSEUM

Welcome to the Newseum, the world's most interactive museum, where five centuries of news history meets up-to-the-second technology on America's Main Street. The Newseum's galleries and theaters will immerse you in the world's greatest news stories — the people, the places and the times. We hope you enjoy your visit!



ANNENBERG THEATER Visitors get in on the action in the 4-D experience.

VISITOR PATH

After you enter the Newseum on Level 1, take the escalators down to the Concourse Level. After visiting the Orientation Theaters and other exhibits, take the glass express elevators up to Level 6, then work your way back down. We want you to see everything the Newseum has to offer!

EXHIBIT HIGHLIGHTS

First Amendment Tablet

Read the 45 words that form the cornerstone of democracy, rendered larger than life in a 74-foot-tall marble tablet.

● **PENNSYLVANIA AVENUE**

Great Hall of News

FOUNDING PARTNER: THE NEW YORK TIMES – OCHS-SULZBERGER FAMILY

Take in the majesty of the 90-foot-high atrium and see the high-definition media screen.

● **LEVEL 1**

Pulitzer Prize Photographs Gallery

Hear from the photographers who captured the world's greatest news photographs.

Warning: Material may be too intense for children.

● **LEVEL 1**

Walter and Leonore Annenberg Theater

FOUNDING PARTNER:

THE ANNENBERG FOUNDATION

Shake, rattle and roll through "I-Witness!", a 4-D film experience. See a visitor services representative for times. Access near north end of Concourse or Level 1. See *warning on p. 19.*

● **CONCOURSE LEVEL / ● LEVEL 1**



GREAT HALL OF NEWS A Bell JetRanger news chopper appears to soar over the atrium.

Berlin Wall Gallery

Stand in the shadow of a three-story guard tower and eight sections of the original wall.

● **CONCOURSE LEVEL**

Changing Exhibits Gallery

FOUNDING PARTNER: ABC NEWS

Now open: "FBI Exhibit: Top News Stories of the FBI's First Century."

● **CONCOURSE LEVEL**

Orientation Theaters

FOUNDING PARTNER: HEARST CORPORATION

Watch films on news and the Newseum.

● **CONCOURSE LEVEL**

Sports Theater

Relive some of the greatest moments in sports history in the documentary "Press Box: The History of Sports Reporting."

● **CONCOURSE LEVEL**

Pennsylvania Avenue Terrace

FOUNDING PARTNER:

THE HANK GREENSPUN FAMILY

Delve into the history of America's Main Street and see dramatic views of the city.

● **LEVEL 6**

NEWSEUM NEWSEUM NEWSEUM NEWSEUM NEWSEUM NEWSEUM NEWSEUM



↑ **SPORTS THEATER** Relive great moments in sports, such as Cal Ripken's record-breaking feat.

→ **NEWS HISTORY** Historic newspaper front pages spanning 500 years anchor the gallery.



↑ **FIRST AMENDMENT** Americans enjoy hard-won freedoms of assembly, speech, religion, press and petition.

→ **PULITZER PHOTOS** Dramatic images capture a glimpse of life.



Front Pages Gallery

Read daily newspaper front pages from around the world.

● LEVEL 6

Big Screen Theater

FOUNDING PARTNERS:

ROBERT H. AND CLARICE SMITH

Watch live news and original video presentations on a 100-foot-long screen.

● LEVEL 5

Great Books Gallery

FOUNDING PARTNER: PULLIAM FAMILY

Page through influential and historic works on freedom and the rights of humans.

● LEVEL 5

News History Gallery

FOUNDING PARTNER: NEWS CORPORATION

Explore the history of news gathering in the Newseum's largest gallery.

● LEVEL 5

First Amendment Gallery

FOUNDING PARTNER: COX ENTERPRISES

Experience true stories behind the five fundamental freedoms guaranteed by the First Amendment.

● LEVEL 4

New Media Gallery

FOUNDING PARTNER: HP

Explore and experience the news as never before. Use the latest interactive technologies to become part of the global news conversation and share your opinions with the world.

● LEVEL 4

9/11 Gallery

FOUNDING PARTNER: COMCAST

Witness the challenges that journalists faced covering the 9/11 terrorist attacks. *Warning: Material may be too intense for children and some visitors.*

● LEVEL 4

Broadcast Studios

FOUNDING PARTNER:

JOHN S. AND JAMES L. KNIGHT FOUNDATION

Live from the Newseum! Studios are home to television and radio broadcasts, including ABC's "This Week" Sunday mornings.

● LEVEL 3

Internet, TV and Radio Gallery

FOUNDING PARTNER: BLOOMBERG

Follow the evolution of electronic news-gathering technology from the sounds of radio to the immediacy of the Internet, and witness its impact through dozens of memorable images and video clips.

● LEVEL 3

Journalists Memorial

Learn about the courageous reporters who died while covering the news.

● LEVEL 3

World News Gallery

FOUNDING PARTNER: TIME WARNER

Compare how news coverage and press freedom differ across the globe, and witness firsthand the challenges and dangers journalists face on the job.

● LEVEL 3

Ethics Center

FOUNDING PARTNER: THE BANCROFT FAMILY

Test your knowledge of ethics through interactive kiosks and a lively game that illustrate the tough decisions journalists must make in their work.

● LEVEL 2

Interactive Newsroom

FOUNDING PARTNER: NBC NEWS

Do you have what it takes to be a reporter? Test your skills at interactive game kiosks, or give a live news update on camera.

● LEVEL 2

CONCOURSE

- Berlin Wall
- Changing Exhibits
- Comics
- Documentary Theater
- First Aid Station
- Food Section and Express Bar
- Learning Center
- Lost and Found
- Orientation Theaters
- Sports Theater
- Stairs/Elevator to 4-D Experience



BERLIN WALL See eight sections of the wall and an East German guard tower.



FOOD SECTION Enjoy fresh sandwiches, salads, coffee and dessert by Wolfgang Puck Catering.



'BLOOD AND INK' Read Civil War front pages (enter next to the 4-D Experience).



Nikon is the exclusive sponsor of "Photo Finish: The Sports Photography of Neil Leifer."

LEVEL 1

- Annenberg Theater
- Coat Check
- Information Desk
- Newseum Store
- Pay Phones
- Pulitzer Prize Photographs
- Stairs/Elevator to 4-D Experience
- Ticketing

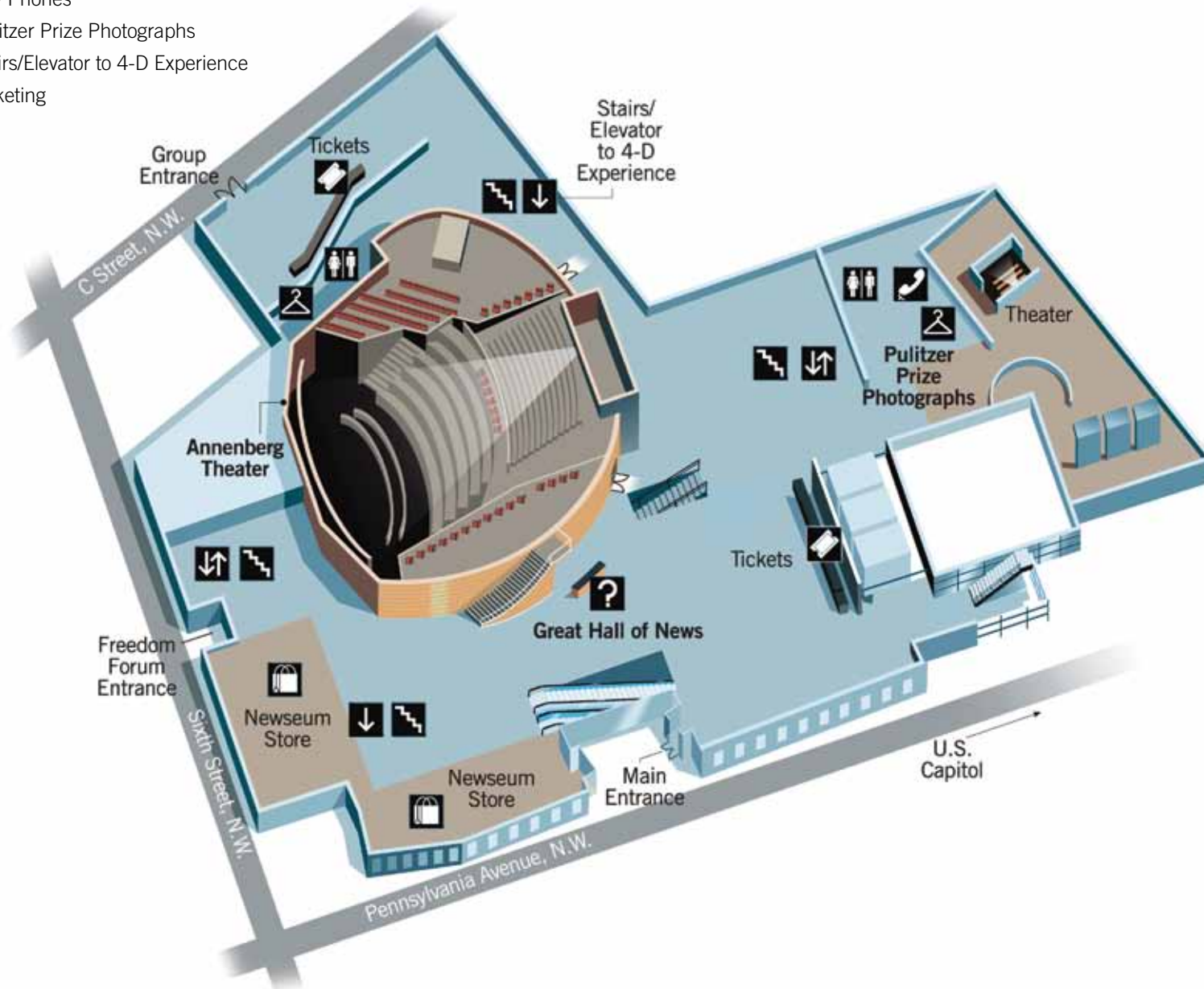

PULITZER PHOTOS The most complete collection of award-winning pictures ever assembled.



PENNSYLVANIA AVENUE ENTRANCE Get the day's headlines, right outside the Newseum.



VISITOR SERVICES Newseum staff, identifiable by their green shirts, stand by to help.

LEVEL 2

Ethics Center
Interactive Newsroom
Newseum Store

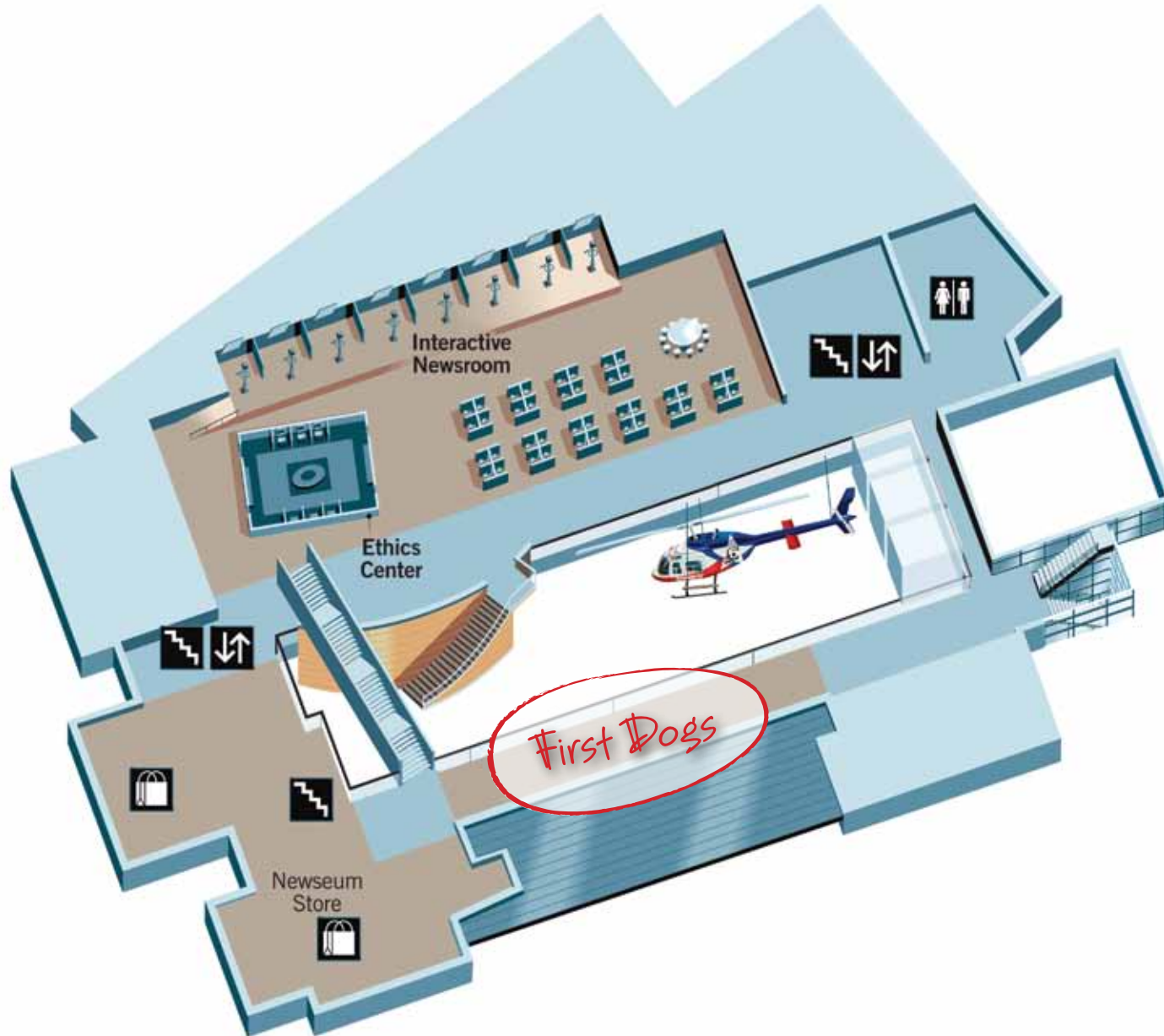

INTERACTIVE NEWSROOM Try reading the news in front of a live camera.



ETHICS CENTER Challenge your friends to a fast-paced game of judgment.



NEWSEUM STORE Take home the Newseum News Hound for the kids, or for a kid-at-heart.

LEVEL 3

- Digital News
- Edward R. Murrow Story
- Internet, TV and Radio
- Journalists Memorial
- Master Control
- Newseum TV Studio
- Pennsylvania Avenue Studio
- World News

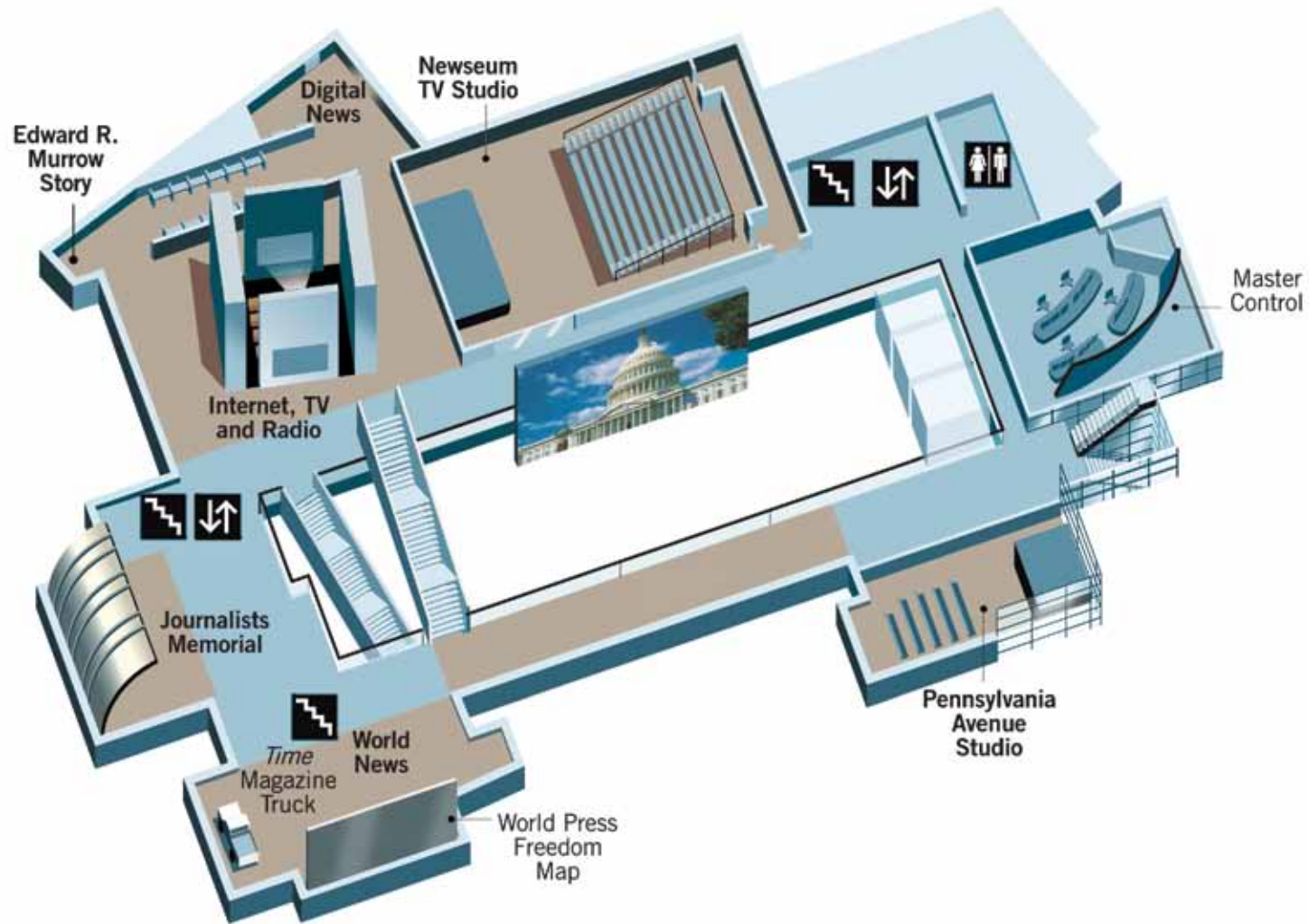

JOURNALISTS MEMORIAL Learn about journalists who died covering the news.



INTERNET, TV AND RADIO Trace the history of electronic news from the 19th century to today.

LEVEL 4

- Big Screen Theater
- First Amendment Gallery
- Five Freedoms Walkway
- New Media Gallery
- 9/11 Gallery
- Special Exhibits

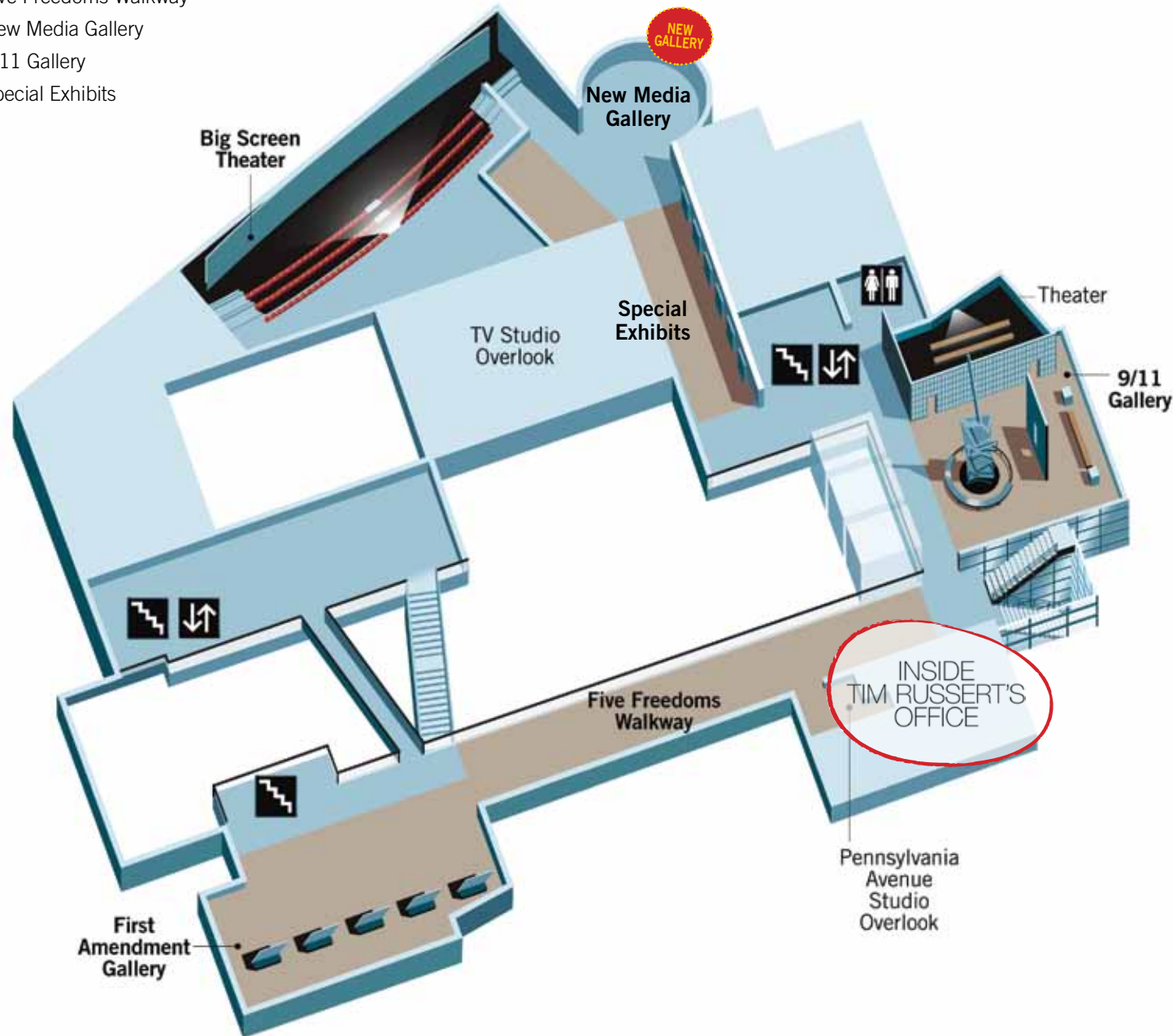

NEW MEDIA GALLERY Play interactive games and join the global media conversation.



9/11 GALLERY See front pages that chronicle the events of that tragic day.



FIRST AMENDMENT Learn the five freedoms guaranteed to every U.S. citizen.

LEVEL 5

- Big Screen Theater
- Don Bolles Car
- Great Books
- News History

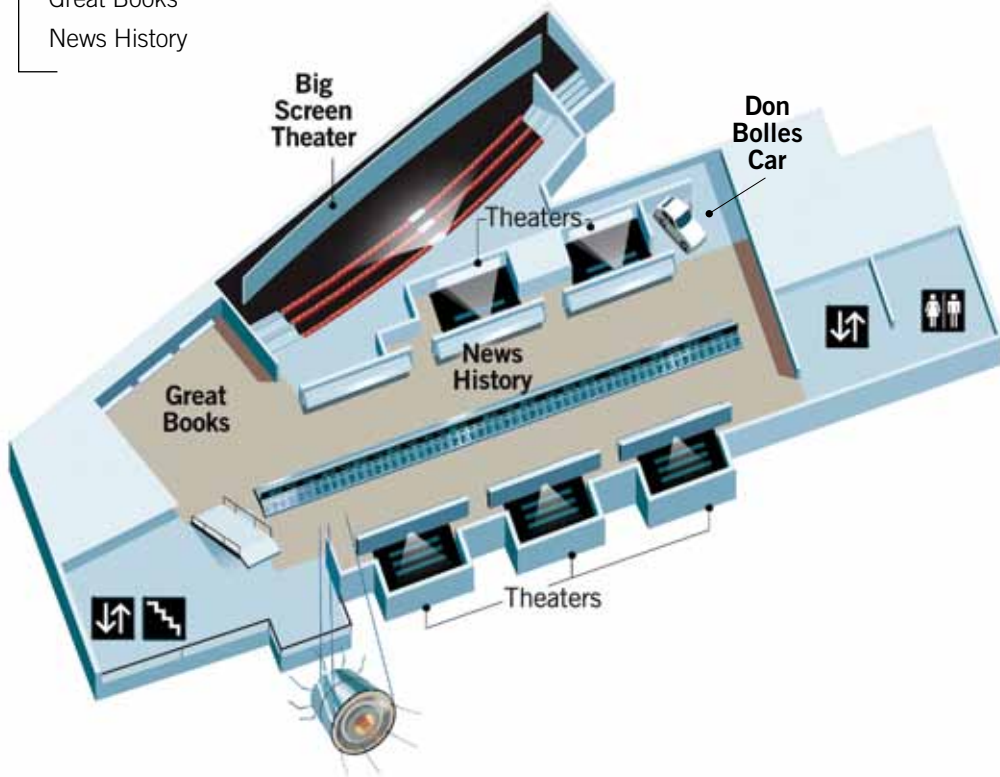

LEVEL 6

- Pennsylvania Avenue Terrace
- Front Pages Gallery
- U.S. Capitol View

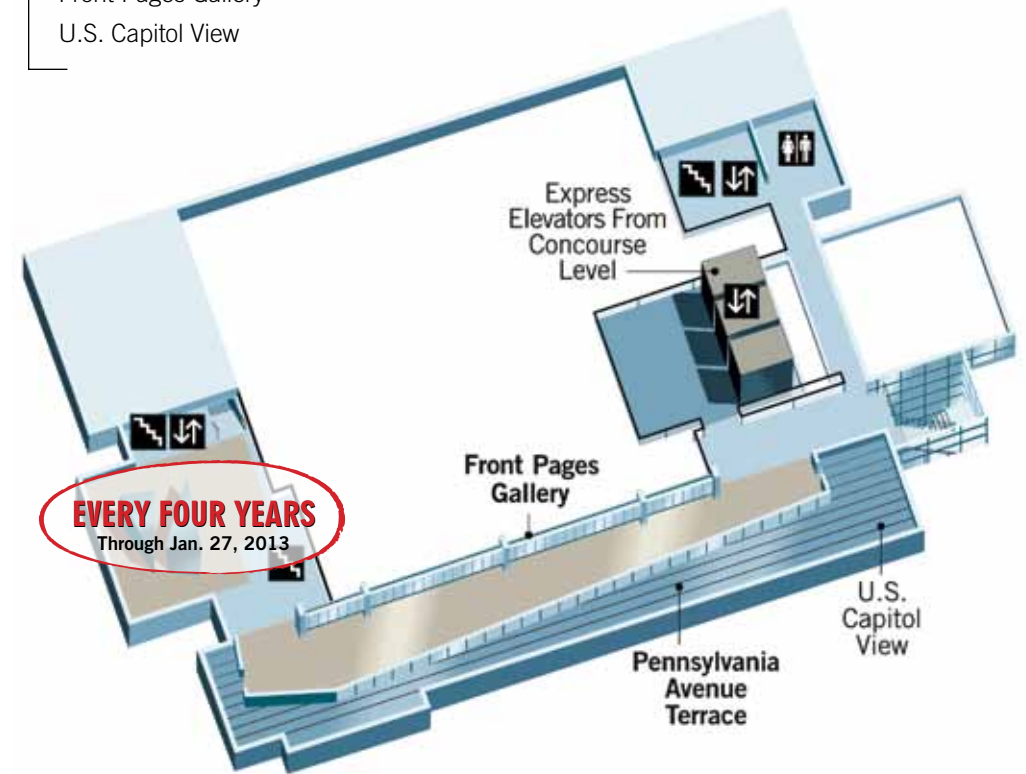

NEWS HISTORY Five theaters and 500 years of history make this gallery a museum unto itself.



NEWS SATELLITE See a replica of ATS 1, which made possible the first live global TV broadcast.



TODAY'S FRONT PAGES Contemplate coverage from across the U.S. and around the world.



TERRACE Take in a majestic view of the Capitol and learn the history of America's Main Street.



WASHINGTON, D.C., AREA

Free Admission for Teacher-Led Field Trips

Public and private school groups (grades 1-12) in the Washington, D.C., area receive free general admission to the Newseum when they visit with their teacher as part of a school group. Free admission for local school groups is co-sponsored by WTOP 103.5 FM and *The Washington Post*.

This special offer includes free admission for students, and free admission for one adult chaperone for every 10 students. Additional chaperones over the 1:10 chaperone ratio will be charged \$15 each.

Summer camps, scout groups and other youth programs qualify for discounted group rates and should contact education reservations at 202/292-6650 or educationprograms@newseum.org.

For information about free student groups, field trips, Learning Center classes, tours and additional teacher resources, visit newseum.org or write to educationprograms@newseum.org.

To qualify for the WTOP and *Washington Post* partnership, schools must be located in one of these areas:
Washington, D.C.: Anne Arundel County, Calvert County, Charles County, Frederick County, Howard County, Montgomery County, Prince George's County, St. Mary's County; **Virginia:** Arlington County, Fairfax County, Fauquier County, Loudoun County, Prince William County, Stafford County, City of Alexandria, City of Fairfax, City of Falls Church, City of Manassas, City of Manassas Park.

At newseum.org, you can:

- Buy tickets
- Play games
- Shop for souvenirs
- Catch up on Newseum news
- Read 800 front pages daily
- Support your favorite museum

and so much more!

Credits: Be a TV Reporter, Ethics Center, Journalists Memorial, Terrace by James P. Blair; Food Section, Pulitzer Gallery, Newseum Store, Visitor Services, Pennsylvania Avenue Entrance, 9/11 Gallery, News History, News Satellite by Maria Bryk; Great Hall of News by Jonathan Ernst; Cal Ripken courtesy Kevin Gilbert; First Amendment Gallery by Scott Henrichsen; Berlin Wall, Newseum exteriors, Annenberg Theater, Internet, TV and Radio, New Media Gallery, Today's Front Pages by Sam Kittner; Blood and Ink by Sarah Mercier; *Boston American* front page, Newseum collection; Olympics in Los Angeles, *The Orange County Register*; censorship protesters by Michael Smith/Getty Images News. Floorplan illustrations by Kevin Rechin.

VISITOR SERVICES

Restrooms are located on every level in the northeast corner.

Elevators are located at the northeast and west corners. Visitors may access the glass express elevators on the Concourse Level.

The Food Section Open daily 11 a.m. to 3 p.m.

Coat check is located on Level 1. Wheelchairs and strollers are available for loan.

Public telephones are available on Level 1.

Lost and found items and first aid are located on the Concourse Level. Ask a visitor services representative for help.

The information desk is located on Level 1.

Tickets are available at the admission desk on Level 1 or online at newseum.org.

The Newseum Store offers museum-quality, one-of-a-kind items, as well as original publications, photo prints, posters, DVDs and unique souvenirs. Open 10 a.m. to 5 p.m.

Please Note Photography and videotaping are not permitted in some exhibit areas in order to protect delicate artifacts.

Your support of the Newseum is greatly appreciated. Gifts to the Newseum are tax-deductible to the extent allowed by law. Write to development@newseum.org or call 888/NEWSEUM to learn more.

Special events are truly extraordinary at the Newseum. Write to eventrentals@newseum.org or call 888/NEWSEUM.

The Source by Wolfgang Puck, adjacent to the Newseum, is open for lunch and dinner. For reservations, call 202/637-6100.

Newseum Hours Open 9 a.m. to 5 p.m. daily. Closed Thanksgiving, Christmas and New Year's Day.

Admission Valid for two consecutive days.
Adults (19 to 64): \$21.95 plus tax
Seniors (65 and older), military and students with valid ID: \$17.95 plus tax
Youth (7 to 18): \$12.95 plus tax
Children (6 and younger): Free
Family Pack: 2 adults and 2 youth, \$49.95 plus tax
Discounts available for groups.

Press Pass Annual Membership Enjoy a year of unlimited admission, priority program seating, special invitations, discounts and more. Visit the admission desk for information.

Be a TV Reporter Go on camera and tape your own newscast, then download your video from newseum.org. \$5 additional charge for video.

Accessibility The Newseum is a fully accessible facility. Elevators that stop on each floor are located on both sides of the building. Wheelchairs, walkers and mobility scooters are available. Assistive listening devices are available upon request for "I-Witness!" and for films in the Documentary Theater. Other theaters feature captioning for the hearing impaired. This Visitors Guide is available in Braille and large print upon request at the Information Desk.

This guide is available in Chinese, French, German, Japanese, Portuguese and Spanish upon request at the Information Desk.

Warning:

Some material in the Newseum may be too intense for children and some visitors.

"I-Witness!" is filmed in 3-D and includes seat movement and other physical special effects. Pregnant women and people with physical ailments should use caution. Motionless seats are available; ask a visitor services representative.

Pub. No. 099-12-NEWS | 5/12 | 100K | BL

Post your review at
tripadvisor.com/newseum



REVIEWERS RANK NEWSEUM AS ONE
OF WASHINGTON, D.C.'S TOP MUSEUMS

“A real surprise. Absolutely
outstanding and fascinating.”

— downstream23, posted Sept. 8, 2011



“We loved it. Our kids loved it.
Our grandchildren loved it.”

— Mutty_L, posted April 17, 2012



“Without a doubt, not to be missed!”

— sgthomas, posted March 14, 2012